

# 1階

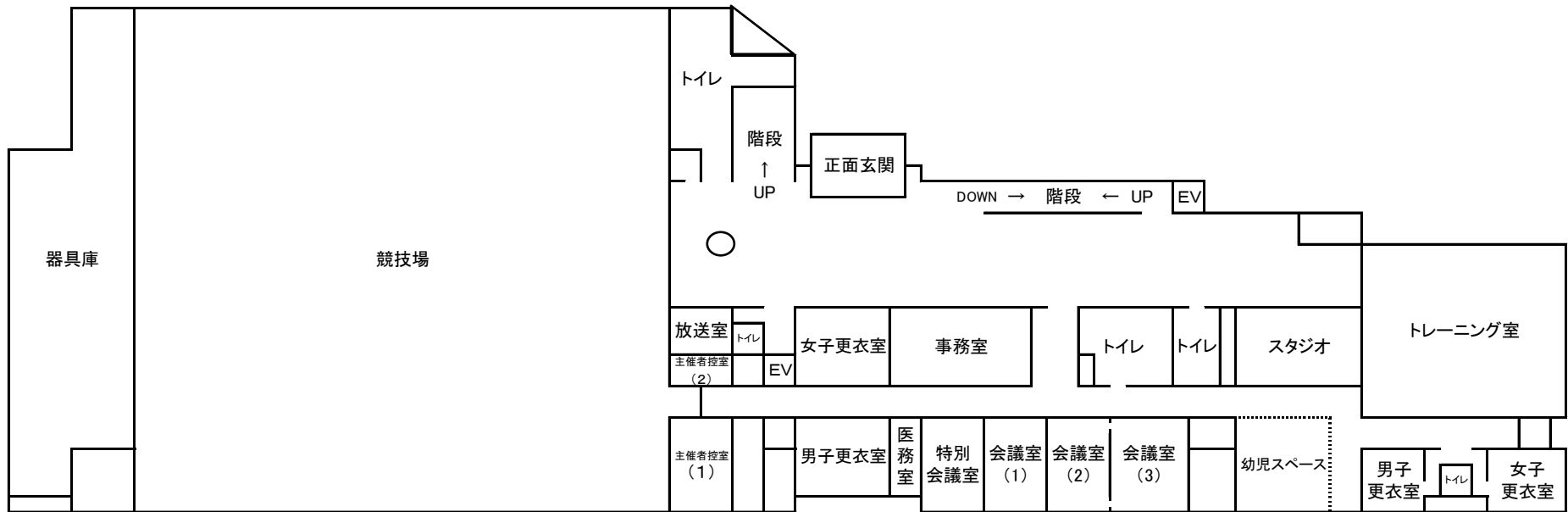

# 2階

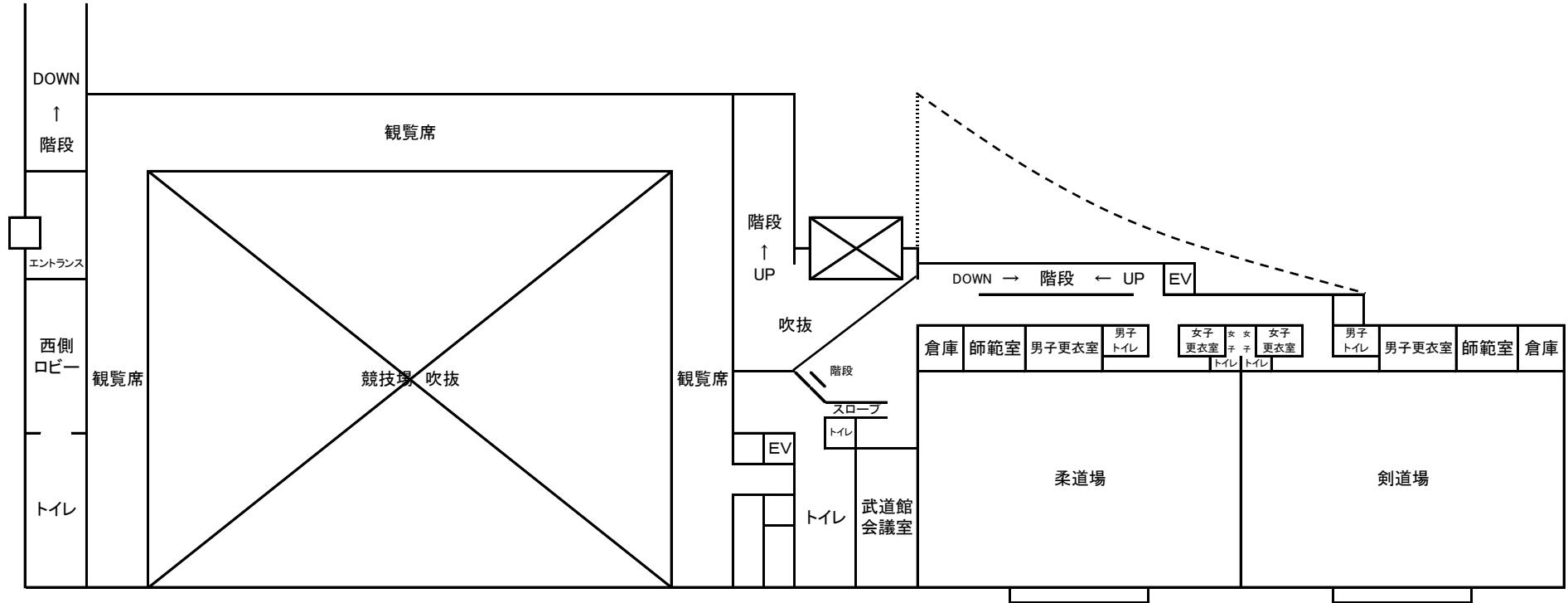

# 3階

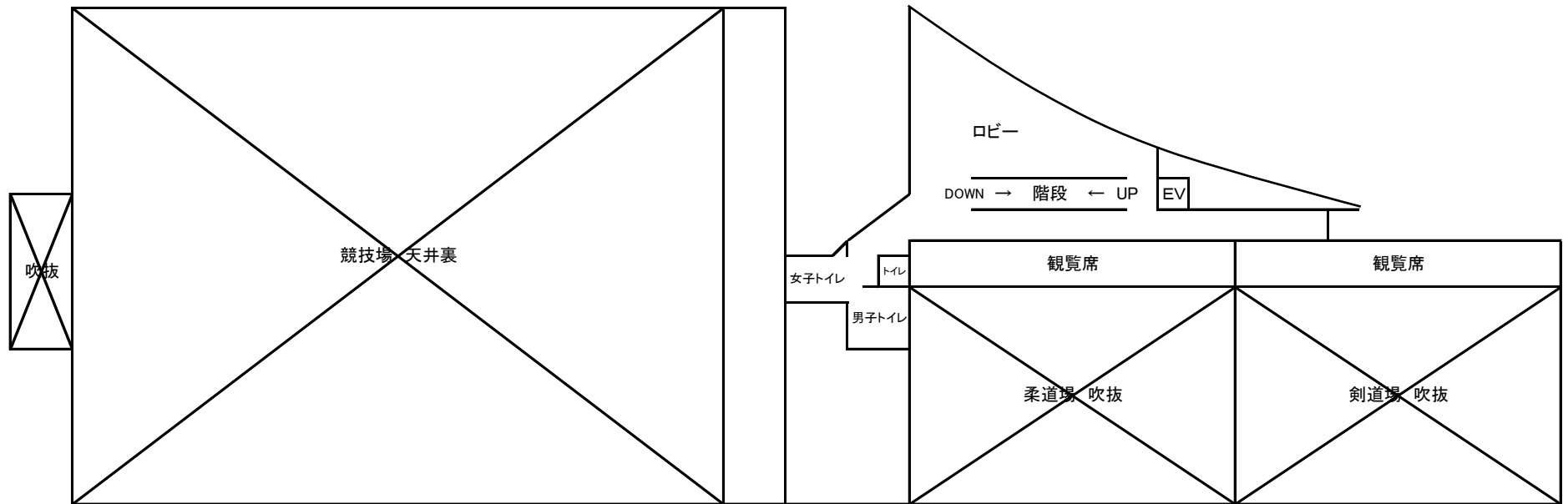

# 4階

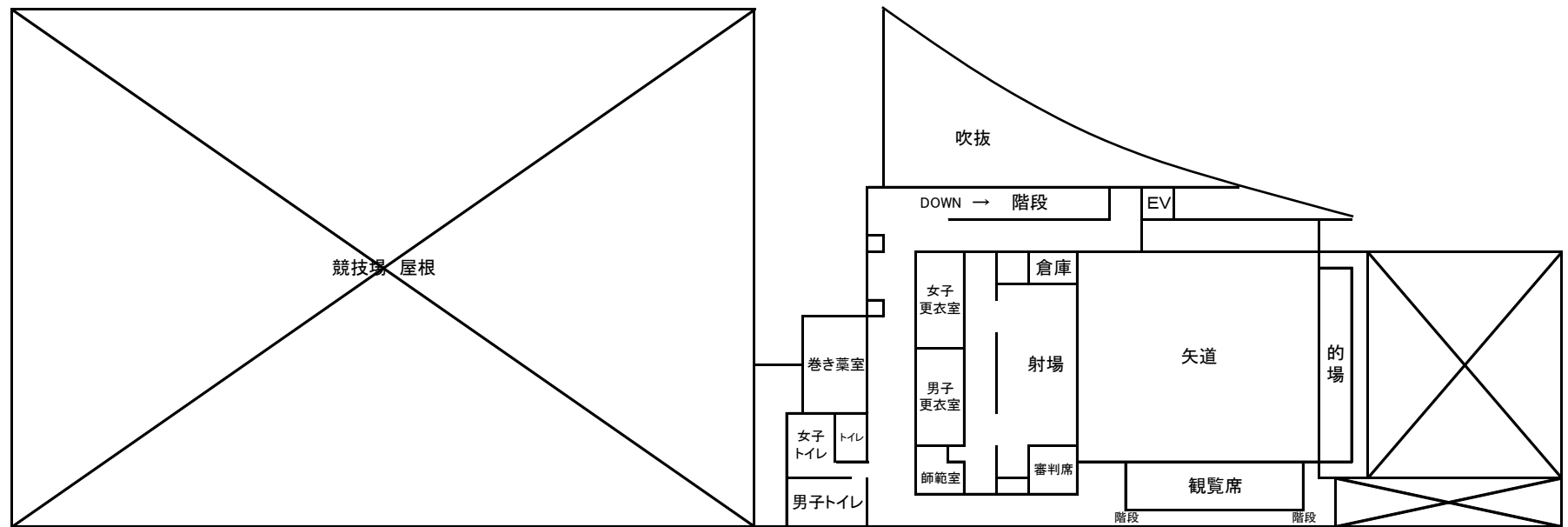

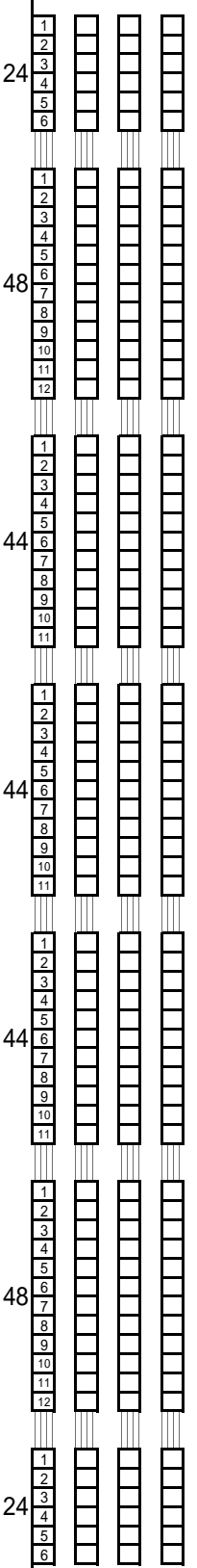

**西**  
固定席 276 席

**北**

固定席 422 席

固定席東側	24 + 48 + 44 + 33 + 44 + 48 + 24	= 265
固定席北側	30 + 60 + 55 + 44 + 44 + 44 + 55 + 60 + 30	= 422
固定席西側	24 + 48 + 44 + 44 + 44 + 48 + 24	= 276
合計		963

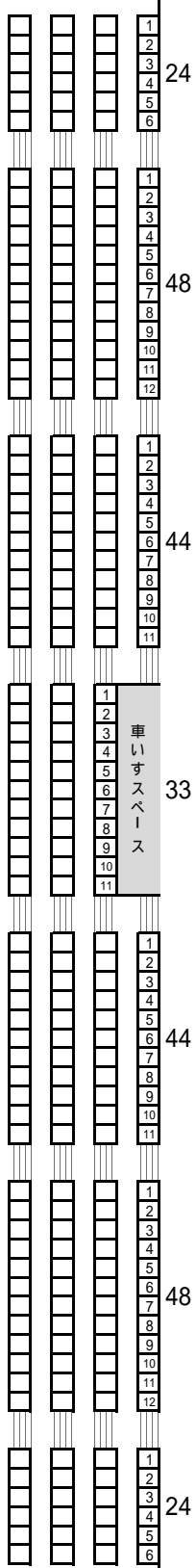

**東**

固定席 265 席

**南**